

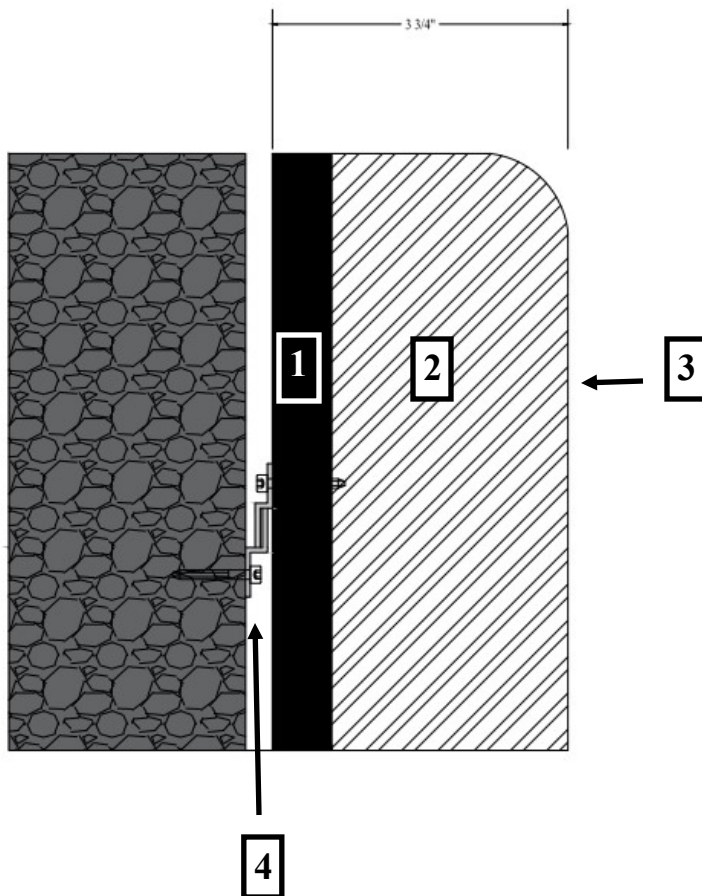

## Wall Padding Detail with Z-Clip



**#1**  
**3/4" Severe Weather AWWA compliant Treated Pine Plywood Sheathing.**

- Primed & Painted with extreme conditions exterior paint.

**#2**  
**3" High Impact Foam**

- Density: 1.50 pcf
- Impression Load: 25% 75-85, 65% 128-145 Support Factor 65/25 1.7 min
- Rebound %: 40-48%
- Tear Resistance: 1.5-2.5 lbs/in
- Static Fatigue: <35% % loss @ 25% ILD

**#3**  
**Advantage MVP Vinyl**

- 18.5 oz/sq yd
- 3000+ hour UV resistance
- Emboss: Course Matte
- Construction: 9 x 9, 1000 x 1000 Denier
- Tongue Tear: 100 x 100 lbs / 1"
- Grab Tensile: 375 x 375 lbs / 1"
- Adhesion: 26lbs / 2"
- Meets CAL117-2013 Flammability Test
- Abrasion: 1000 cycles
- Rot, Mildew, & Fungus Resistant
- Available in 18 color choices

**#4**  
**1.5" Aluminum Z Clip**

- Placed at bottom & top of pad and an additional z clip placed in middle for pads 8' in height.
- Attached with 1" Galvanized Screw



WEB: [www.unlimitedsportssolutions.com](http://www.unlimitedsportssolutions.com)

EM: [sales@unlimitedsportssolutions.com](mailto:sales@unlimitedsportssolutions.com)

PH: 531-207-9331